



EN KITCHEN SCALES

KS-01

Instruction manual





Thank you for purchasing
the **ZEST by ZEPTER** Kitchen Scales.

We designed this product with convenience and efficiency in mind, so you can enjoy your Kitchen Scales for years to come. This guide will help you maximize the benefits of your ZEST by Zepter Kitchen Scales. Please review these instructions carefully to understand its operation and maintenance procedures.



Scan the QR code
to access to
another languages

CONTENT

01	SAFETY INSTRUCTIONS	1
02	KNOW YOUR KITCHEN SCALES	3
03	BEFORE FIRST USE	4
04	INSTRUCTIONS FOR USE	5
05	CLEANING AND MAINTENANCE	7
06	TROUBLESHOOTING	8
07	PRODUCT COMPLIANCE AND DISPOSAL INFORMATION	9
08	CONTACT ZEPTER	9
09	WARRANTY STATEMENT	10
10	WARRANTY CARD	11

01 SAFETY INSTRUCTIONS

The safety precautions and the instruction manual are part of the appliance. Read them carefully before using your new appliance for the first time. Keep them in a place where you can find and refer to them later on.

Please keep the instructions, the warranty card, the sales receipt, and, if possible, the gift box with the inner packaging.

Failure to follow these instructions may result in injury or damage to the appliance.



WARNING

To avoid accidents or misuse, children should only use the scales under adult supervision.



WARNING

Keep the appliance and its packaging materials out of reach of children to avoid risk of suffocation or misuse.

- This appliance is intended solely for weighing food ingredients in domestic environments.
- Any other use is considered improper and may result in hazards.
- This product is not suitable for commercial or medical applications.
- Do not use the scales if they are damaged, unstable, or have a cracked surface.
- Always place the scales on a flat, stable, and dry surface (e.g., a kitchen countertop).
- Do not use on soft, uneven, wet, or slippery surfaces.
- Place items centrally on the weighing platform to ensure stability and accuracy.
- Do not overload the scales. Maximum load: 5 kg.
- Handle food and containers carefully to prevent items from falling or causing impact damage.
- Insert batteries according to the polarity symbols (+/-) indicated in the compartment.
- Incorrect insertion may cause batteries to leak, overheat, or explode.
- Do not mix old and new batteries or different battery types.
- Remove batteries if the appliance will not be used for an extended period.

- Dispose of used batteries in accordance with local environmental regulations. Do not dispose of them in household waste.
- If battery leakage occurs, avoid contact with skin or eyes. In case of contact, rinse immediately with water and seek medical advice.
- The appliance is not waterproof.
- Do not immerse the appliance in water or allow liquids to enter the housing.
- Clean the weighing surface with a soft, slightly damp cloth.
- Do not use abrasive cleaners, solvents, or scouring pads.
- Do not expose the appliance to high humidity, extreme temperatures, or direct sunlight.
- Do not place heavy objects on the scales during storage, as this may damage the sensors.
- Do not open, modify, or repair the appliance yourself.
- Unauthorized repair may lead to electric shock, malfunction, or void the warranty.
- If the appliance is damaged or malfunctions, contact Zepter service center.
- This appliance may be used by persons (including children) with reduced physical, sensory, or mental capabilities, or lack of experience and knowledge, only under supervision or if they have been instructed in the safe use of the appliance and understand the hazards involved.

02 KNOW YOUR KITCHEN SCALES

Key Function

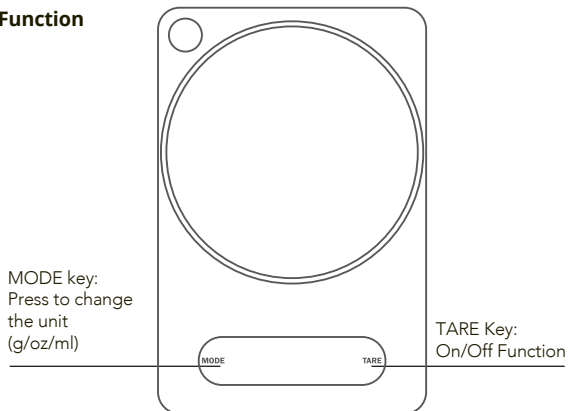

Switch off

- The scales will switch off after press " TARE " for 2 seconds.
- The scales will automatically switch off after approximate 120 seconds when no operation.

Unit changes (g/oz/ml)

Press " MODE " once, the unit will be exchanged from g/ oz/ water (ml)/ milk (ml).

ml Measurement

Put a container on the platform, press " TARE " to clear the weight of container. Then put water or milk into it, press" MODE " till ml to check the volume.



Specification:

Max. Capacity:	5000 g
Min. Capacity:	0.5 g
Tolerance:	0.1 g
Unit:	g/ oz/ water (ml)/ milk (ml)
Power:	2 x 1.5V AAA batteries

03 BEFORE FIRST USE

Before using your kitchen scales for the first time, please follow these steps to ensure proper setup and accurate operation:

Unpacking the Device

Carefully remove the scales and all packaging materials from the box. Inspect the device for any visible damage. Do not use the appliance if it appears damaged.

Cleaning

Wipe the weighing surface gently with a soft, damp cloth to remove any dust or residue from manufacturing or packaging. Do not immerse the device in water or use abrasive cleaning agents.

Inserting the Batteries

Open the battery compartment on the underside of the scales. Insert the required batteries (2 - AAA), ensuring correct polarity (+/-). Close the battery compartment securely. If the display does not turn on, check the battery orientation or replace with new batteries.

Placing the Scales

Set the scales on a flat, stable, and vibration-free surface. Avoid placing the scales near heat sources, in direct sunlight, or in humid environments.

Powering On

Press the tare button to turn on the device. Wait a few seconds for the display to initialize. The scales is now ready to use.

By properly setting up your kitchen scales before the first use, you ensure accurate measurements and extend the lifespan of the device.

04 INSTRUCTIONS FOR USE

Weighing

Step 1: Place the scales on a hard and flat surface.

Step 2: Press "TARE" once, the LCD display will show zero.

Step 3: Put the food item on the platform, the weight will be displayed.

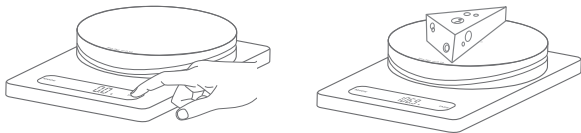

TARE function

Step 1: Put the container on the platform, the LCD display will show the weight of the container.

Step 2: Press "TARE" to clear the weight of the container (reset to zero). Then put the food into the container, the LCD display will show the weight of food only. Repeat press "TARE" to weight more different foods.

Step 3: The LCD display will show the negative value of container if you remove the food and container from the platform together, please press "TARE" again, the display will show zero in 2 seconds.

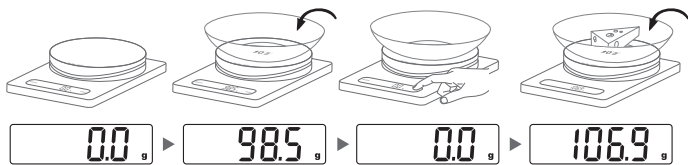

Please note:

If tare the weight less than 100g, it will show

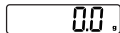

If tare the weight which more than 100g, it will show



Insert the battery

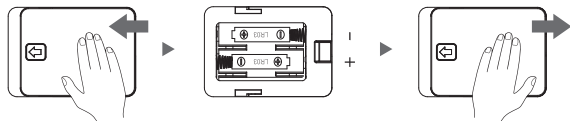

- Open the battery cover.
- Install 2 x 1.5V AAA batteries as shown.
- After installing the battery, put back the battery cover and push the cover backward.
- Insert batteries according to the polarity symbols (+/-) indicated in the compartment.



WARNING

Incorrect insertion may cause batteries to leak, overheat, or explode.

05 CLEANING AND MAINTENANCE

Proper care and maintenance will help ensure accurate performance and extend the lifespan of your kitchen scales.

- Store the scales in a room temperature, do not expose the appliance to high humidity, extreme temperatures, or direct sunlight.
- Do not store scales outdoors.
- Do not place heavy objects on the scales during storage, as this may damage the sensors.
- Do not attempt to disassemble, repair, or modify the scale yourself.

For gentle cleaning:

1. Turn off the scales and remove the batteries before cleaning.
2. Clean the weighing surface with a soft, slightly damp cloth.

NOTE! The appliance is not waterproof.



NOTE! Do not immerse the appliance in water or allow liquids to enter the housing.

- Do not use abrasive cleaners, solvents, or scouring pads.
- Always dry the scales with a clean, dry cloth.

Battery Maintenance:

- Replace the batteries when the low battery indicator appears on the display.
- Remove the batteries if the scale will not be used for an extended period to prevent corrosion.
- Use only the battery type specified in the manual. Do not mix old and new batteries or different battery types.
- If battery leakage occurs, avoid contact with skin or eyes. In case of contact, rinse immediately with water and seek medical advice.

06 TROUBLESHOOTING

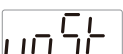
Display	Problem	Reason	Solution
	Overload indication	The scales is overloaded (more than 5 kg).	Remove a heavy item from the scales immediately to prevent damage.
	Low power indication	Battery power is low. The scales will turn off automatically.	Open the battery compartment and replace the batteries.
	Incorrect positioning	The scales is placed on an uneven or soft surface.	Place the scales on a hard, flat, and even surface.
	Inaccurate measurement	The scales is placed on an uneven or soft surface.	Place the scales on a hard, flat, and even surface.
	Fluctuating measurements	The scales is placed on an uneven or soft surface.	Place the scales on a hard, flat, and even surface.

- Do not open, modify, or repair the appliance yourself.
- Unauthorized repair may lead to electric shock, malfunction, or void the warranty.
- If the appliance is damaged or malfunctions, contact the authorized service center or distributor.

07 PRODUCT COMPLIANCE AND DISPOSAL INFORMATION



At the end of its service life, this product may not be disposed of in the normal household waste, but rather must be disposed of at a collection point for recycling electrical and electronic devices. The materials are recyclable according to their labelling. You make an important contribution to protecting our environment by reusing, recycling or utilizing old devices in other ways. Please ask the municipal administration where the appropriate disposal facility is located.

NOTE! Used batteries must not be disposed of as household waste. Do not incinerate batteries because they might explode at high temperature. Contact your local authority for information concerning reclamation and disposal of batteries

08 CONTACT ZEPTER

Home Art & Sales Services AG
Sihleggstrasse 23,
CH-8832 Wollerau,
Switzerland

Zepter International Poland Sp. z o.o.
ul. Domaniewska 37,
PL-02-672 Warsaw,
Poland

quality@zepter.com
www.zestbyzepter.com

QR code to Zepter online store



09 WARRANTY STATEMENT

Thank you for choosing a ZEST by Zepter product. We take pride in providing high-quality appliances, where a design isn't just something you look at—it's something you feel.

Warranty Coverage:

This product is covered by a 2-Year limited warranty from the date of original retail purchase. During the warranty period, the manufacturer will repair or replace (at its discretion) any part of the product that is found to be defective in materials or workmanship, under normal household use and in accordance with the operating instructions.

What Is Covered:

This warranty covers defects in materials or manufacturing, electrical or mechanical malfunctions under normal usage, and the replacement or repair of faulty components at no charge.

What Is Not Covered:

Damage caused by misuse, abuse, or neglect. Failure to follow the instructions in the user manual. Normal wear and tear (e.g., scratches, discoloration, or worn-out parts). Accidental damage, fire, flood, or other external causes. Unauthorized repairs or modifications.

Conditions for Warranty Service:

A valid proof of purchase (original receipt or invoice) is required. The warranty period is not extended by repair or replacement. All servicing must be performed by an authorized service center.

How to Obtain Warranty Service:

If you experience any issues with your product, refer to the Troubleshooting section of the user manual.

If the issue persists, contact our Customer Support team:

Email: _____

Phone: _____

Website: _____

Please have your item number, serial number, and proof of purchase ready when contacting us.

10 WARRANTY CARD

Customer Information:

Name _____

Address _____

Phone Number _____

Email _____

Date of Purchase ____ / ____ / ____

Place of Purchase _____

Item Number _____

Serial Number _____

Lot Number _____

To ensure long-lasting performance and safe operation, please follow all safety precautions, usage instructions, and maintenance guidelines provided in this manual.

ZEPTEK OWNED COMPANIES

BELARUS , Minsk	ITALY , Milan	ROMANIA , Bucharest
BULGARIA , Sofia	JORDAN , Amman	RUSSIA , Moscow
CANADA , Toronto	KAZAKHSTAN , Almaty	SERBIA , Belgrade
CZECH REP. , Prague	LATVIA , Riga	SLOVAKIA , Bratislava
CROATIA , Zagreb	LITHUANIA , Vilnius	SPAIN , Madrid
EGYPT , Cairo	MOLDOVA , Chisinau	UKRAINE , Kiev
ESTONIA , Tallinn	POLAND , Warsaw	USA , North Bergen
HUNGARY , Budapest	PRINCIPALITY OF MONACO , Monte Carlo	

ZEPTEK DISTRIBUTORS

ALBANIA, Living Longer, Exclusiv Sh.p.k
ALGERIA, Newtech Algerie Division
ARMENIA, Travelon Ltd., Afina LLC
AZERBAIJAN, Royal Home Design LLC
AUSTRALIA, Dioswell PTY LTD, Zepter World Australia
AUSTRIA, Vienna, ZEBIZZCLUB GmbH
BANGLADESH, Adora BD Limited
BELGIUM, Haromed BVBA
BOSNIA AND HERZEGOVINA, Sarajevo, Banja Luka
CHINA, Shenzhen Shande Brothers Medical Biotechnology Co.Ltd
CYPRUS, Life's Quality Ltd
DENMARK, Govinda Consult APS
DOMINICAN REPUBLIC, Medicaluz
FRANCE, Paris HITEC Environment
GEORGIA, Limited Liability LLC
GERMANY, Sollingen, Sefeld MZV Deutschland GmbH
GUADALOUPE, SAS BEE'CONFORT
HOLLAND, Corrective Cosmetics Haromed BVBA
HONG KONG, Wessen Group Limited, Solutions Health Care, Gold Beauty Ltd.
ISRAEL, A.L.N. Import LTD
JAPAN, Aglex Inc.
KOSOVO, Living Longer, Exclusiv Sh.p.k
KUWAIT, Healthy Home Trading Co.
MACAU, Wessen Group Limited
MACEDONIA, Skopje, Exclusiv Sh.p.k
MAROCCO, Lilimpharm
MONGOLIA, Standlab Co Ltd
MONTENEGRO, Zepter d.o.o Podgorica, Exclusiv Sh.p.k
NEW ZEALAND, AJE Lifestyles Limited
NORWAY, Uno Vita AS Nailit A/S
PHILIPPINES, BCP Dermatological Corp
Saudi Arabia, Zepter Pandragora, Sagrama FZ-LLC
SINGAPORE, Zen'Yu Pacific Pte Ltd.
SLOVENIA, Slovenj Gradec, Status d.o.o. Metlika
SOUTH KOREA, Seoul, Angel Korea Ltd., Dooil GL Co.,LTD
SWEDEN, Galo Medical AB,
SWITZERLAND, Wollerau, Z-Elite GmbH, Life Resonance AG, Physiotherapie 011
TURKEY, Derma Medikal Kozmetik ithalat İhracat Ve Tic.Ltd.Şti.
UAE, Scarlett Trading Co., Zepter ME Trading LLC, Sagrama FZ-LLC
UK, Colour Ministry, UK
UZBEKISTAN, Tashkent, OOO Blayza
Home Art & Sales Services AG
Sihleggstrasse 23,
CH-8832 Wollerau,
Switzerland